



7" TFT DIGITAL LCD Monitor

for MXN-HD7DMQ - Owner's Manual

• I • N • D • E • X •

Package Contents	03
Operation	04
System Setting	05
Function	05
Picture	06
AUX Picture	06
Normal/Mirror	06
Camera Trigger	07
Distance Marker	07
Auto Picture Scan	08
Camera Name	08
Speed Switch	09
Menu	10
Split	10
Triple	10
Quad	11
Distance Marker Adjust	12
Lock On/Off Function	13
Scan On/Off Function	13
Installation	14
Connection	16
Specification	17





PACKAGE CONTENTS

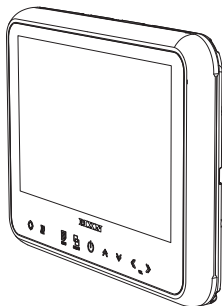

MONITOR

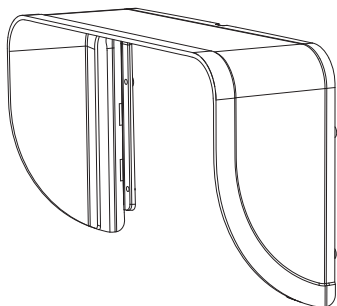

SUNVISOR



SUNVISOR SCREWS



CABLE CLIP



BRACKET SCREWS



STAND BRACKET



MANUAL

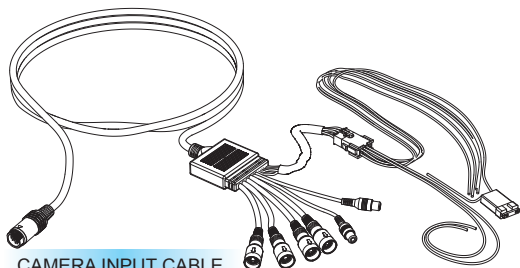

CAMERA INPUT CABLE

ITEM	Q'TY
MONITOR	1
SUNVISOR	1
SUNVISOR SCREW	4
STAND BRACKET	1
BRACKET SCREW	3
CABLE CLIP	2
CAMERA INPUT CABLE	1
MANUAL	1



OPERATION

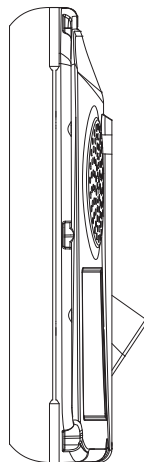
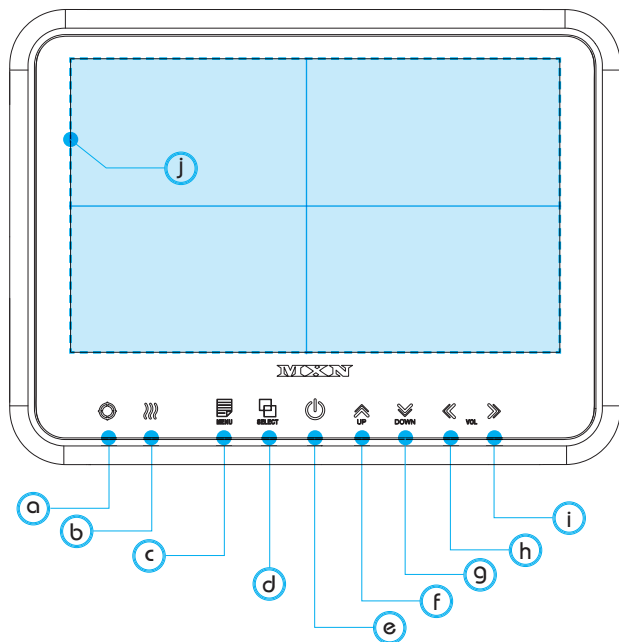

A. DAY/NIGHT SENSOR (CDS)

Automatic brightness control sensor.

B. HEATER LAMP

Orange color will be illuminated in case heater function is activated.

C. MENU

Press [MENU] button for system setting.

D. SELECT

Press [SELECT] button to select the respective channel.
[CAM1 - CAM2 - CAM3 - CAM4 - AUX - SPLIT - TRIPLE - QUAD - CAM1...]

E. POWER

Press [POWER] button to turn on/off the monitor.

F. UP

Press [UP] button to select split screen channel.
[SPLIT - TRIPLE - QUAD - SPLIT...]
Use [UP] button to navigate the menu upward for system setting.

G. DOWN

Press [DOWN] button to select camera AUX channel
[CAM1 - CAM2 - CAM3 - CAM4 - AUX - CAM1...]
Use [DOWN] button to navigate the menu downward for system setting.

H. LEFT

Press [LEFT/RIGHT] button to adjust monitor volume.

I. RIGHT

Use [LEFT/RIGHT] button to change OSD setting during system setting.

J. VIEW AREA



SYSTEM SETTING

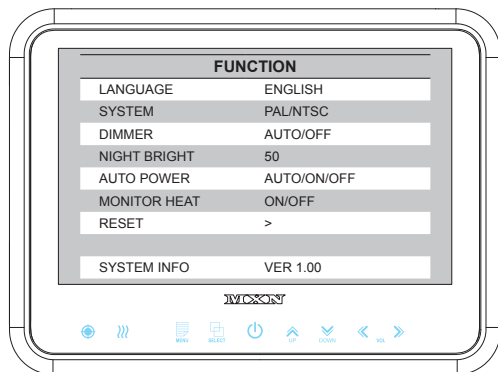

RESET

Press **>>** button to go the factory default setting.

SYSTEM INFO.

Refers to system information of the monitor.

FUNCTION

LANGUAGE

Provide 6 Multi-lingual OSD [ENGLISH, SWEDISH, DANISH, NORWEGIAN, DUTCH, FINNISH].

Select the preferred **LANGUAGE**.

SYSTEM

Select **NTSC/PAL**

DIMMER (Automatic Brightness Control)

Select **AUTO** or **OFF** to have Automatic or Manual brightness of the monitor.



REMARK: By activating **DIMMER AUTO** function, the monitor adjusts the brightness according to the environment.

NIGHT BRIGHT (Brightness during night conditions)

Select the DIMMER to **AUTO** and adjust the value of the backlight into the required setting. During night conditions the backlight will automatically perform brightness according to this setting.

AUTO POWER

Select monitor activation function as below.

[AUTO] Monitor keeps the last setting in memory.

[ON] Monitor starts up **Power-ON** mode automatically.

[OFF] Monitor starts up **Stand-By** mode automatically.

MONITOR HEATER

Select **MONITOR HEATER ON** to have automatic heating function in order to enable fast picture start during extreme cold weather condition.



Remark: During **MONITOR HEATER ON** mode,

Heating activates automatically when the temperature of inside monitor is below 0 degree Celcius.

When the temperature of inside monitor is over 0 degree Celcius, heating stops automatically.



SYSTEM SETTING

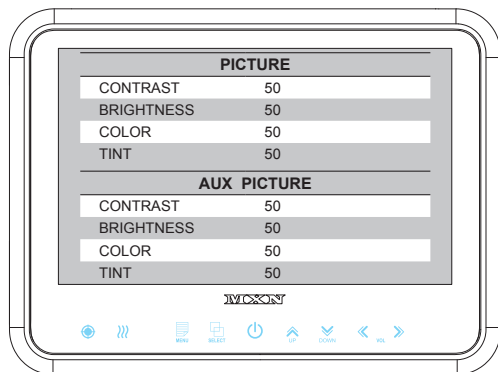

PICTURE

Press [LEFT/RIGHT] button to adjust preferred **PICTURE** of the monitor.

PICTURE MENU adjust **PICTURE** of CAM1, CAM2, CAM3, CAM4, SPLIT, TRIPLE, QUAD MODE

AUX PICTURE MENU adjust **PICTURE** of **AUX MODE**

User can adjust picture setting value for 「**CAMERA CHANNELS**」 and 「**AUX CHANNEL**」 separately.

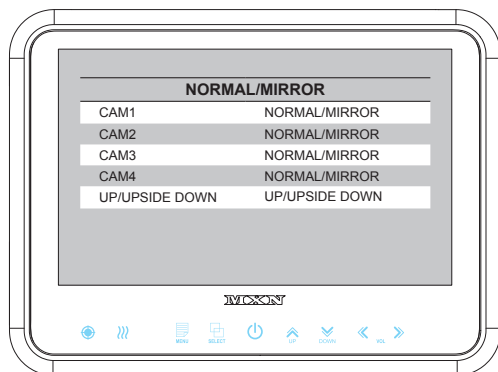

NORMAL/MIRROR

NORMAL/MIRROR

Each camera picture (CAM1/CAM2/CAM3/CAM4) can be switchable as **NORMAL/MIRROR** image.

UP/UPSIDE DOWN

Camera pictures can be switchable as **UP/DOWN** image.

7" TFT DIGITAL LCD MONITOR

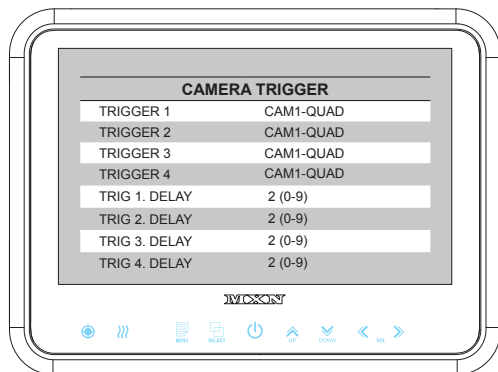

CAMERA TRIGGER

TRIGGER 1/2/3/4 (Trigger source selection)

Select the required trigger source at CAM1/CAM2/CAM3/CAM4/AUX/SPLIT/TRIPLE/QUAD

REMARK

TRIGGER PRIORITY: TRIGGER 1 > TRIGGER 2 > TRIGGER 3 > TRIGGER 4

TRIG. DELAY

When a **TRIGGER** wire is connected to a pulse DC power signal (e.g. direction indicator lights) then the [TRIGGER DELAY] function avoids repeating **ON/OFF** of the monitor.

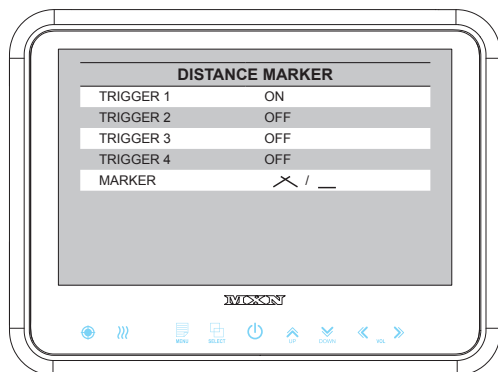

DISTANCE MARKER

Select **ON** to have **DISTANCE MARKER** for CAM1, CAM2, CAM3, CAM4. **DISTANCE MARKER** is displayed as the trigger signal is activated.

MARKER

Select of **DISTANCE MARKER**. ✗ or _



SYSTEM SETTING

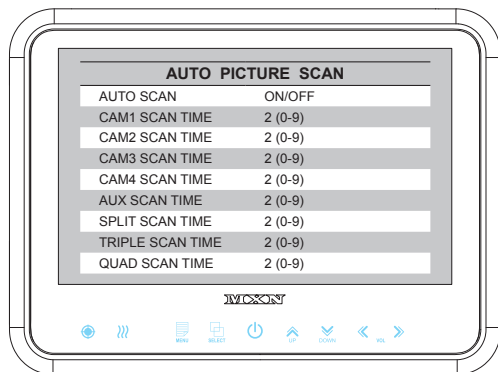

AUTO PICTURE SCAN

Each scanning time of CAM1/CAM2/CAM3 /CAM4/AUX/SPLIT/TRIPLE/QUAD can be selected.

REMARK

If the **SCAN TIME** is set as [0], monitor skips its channel during the scanning.
Press [UP] button for 4 seconds to **ACTIVATE/INACTIVATE** auto scanning function.

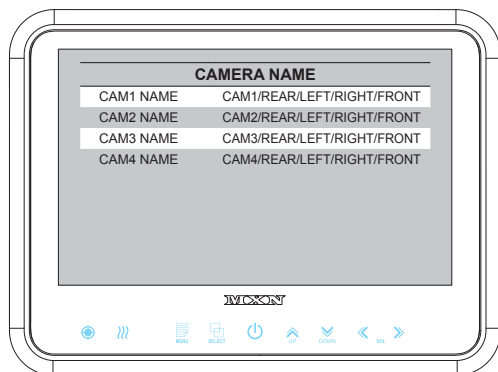

CAMERA NAME

CAMERA NAME can be selected as CAM1, 2, 3, 4/REAR/LEFT/RIGHT/FRONT.

7" TFT DIGITAL LCD MONITOR

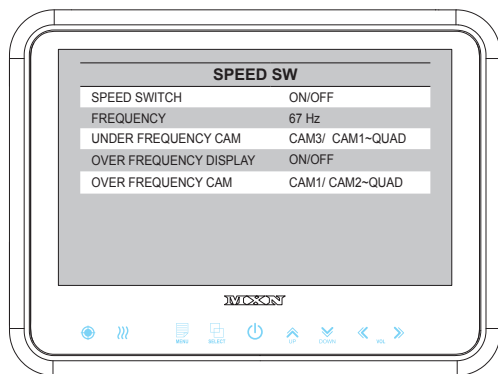

SPEED SWITCH

The orange wire needs to be connected with the vehicle's tacho signal and via **MENU** the **SPEED SWITCH** needs to be selected **ON**. At **FREQUENCY** 67Hz setting (and most common used tacho signal) the selected camera will be displayed during a speed of 0~33km/h. Select the concerning camera via 『**UNDER FREQUENCY CH:**』 (At different type tacho signals the **FREQUENCY** needs to be adjusted into higher or lower value than this example)

Over 33km/h(72Hz) the selected camera will be switched **OFF** automatically. When the speed slows down, then the selected camera will be switched **ON** automatically again at 30km/h. Instead of automatic switch **OFF** at a speed over 33km/h it is also possible to activate another video source, such as a navigation picture from an optional navigation computer. In this case user needs to select 『**OVER FREQUENCY DISPLAY: ON**』 and user needs to select 『**OVER FREQUENCY CH:**』

In case of **TRIGGER** activation during 『**SPEED SWITCH ON**』 mode, then **TRIGGERS 1~4** will overrule 『**SPEED SWITCH**』 function.



MENU

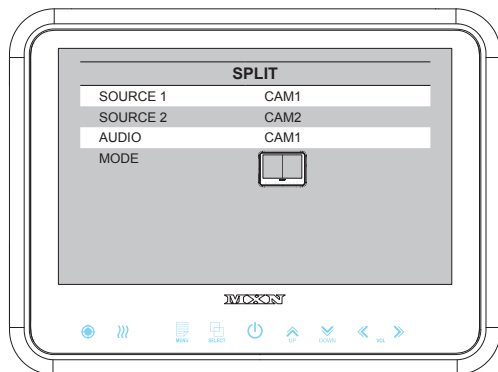

SPLIT

SOURCE 1

Select S1 Camera(CAM1~CAM4).

SOURCE 2

Select S2 Camera(CAM1~CAM4).

AUDIO

Select SPLIT of Audio(CAM1~CAM4).

MODE

Select SPLIT MODE

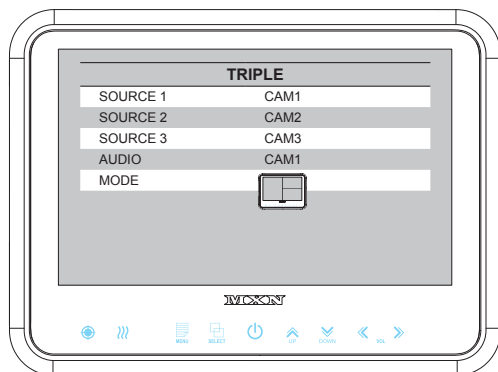
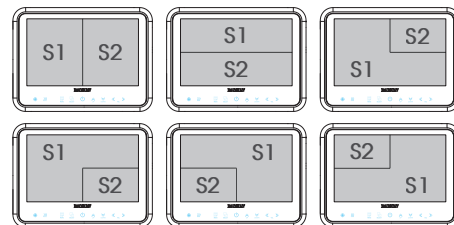

TRIPLE

SOURCE 1

Select S1 Camera(CAM1~CAM4).

SOURCE 2

Select S2 Camera(CAM1~CAM4).

SOURCE 3

Select S3 Camera(CAM1~CAM4).

AUDIO

Select TRIPLE of Audio(CAM1~CAM4).

MODE

Select TRIPLE MODE



7" TFT DIGITAL LCD MONITOR

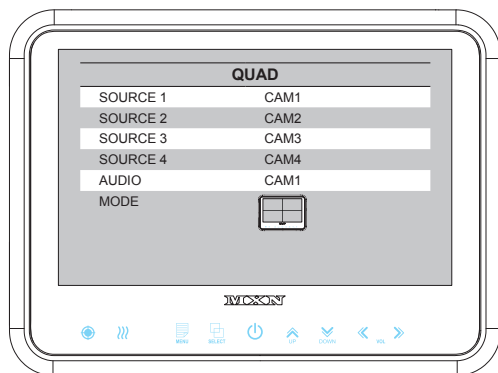

QUAD

SOURCE 1

Select S1 Camera(CAM1~CAM4).

SOURCE 2

Select S2 Camera(CAM1~CAM4).

SOURCE 3

Select S3 Camera(CAM1~CAM4).

SOURCE 4

Select S4 Camera(CAM1~CAM4).

AUDIO

Select QUAD of Audio(CAM1~CAM4).

MODE

Select QUAD MODE

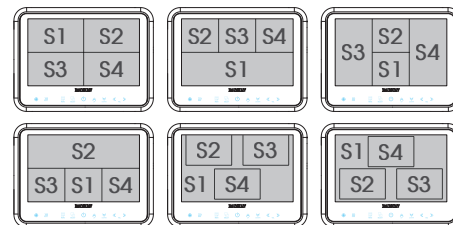



MENU

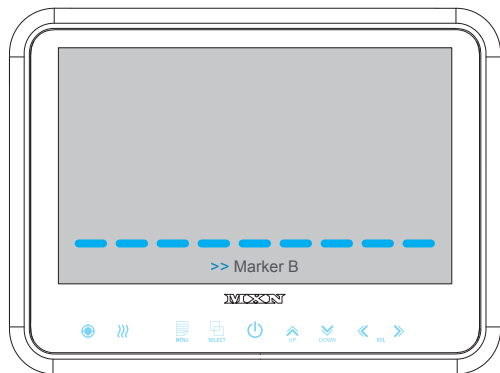
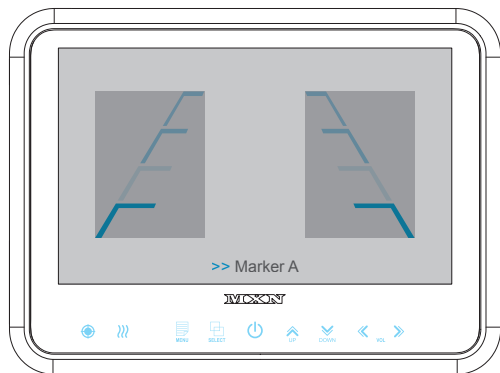

DISTANCE MARKER ADJUST

User can adjust location of distance marker.

Marker A- Parking line

At Power **ON** mode, select distance marker by pressing **[UP/DOWN]** buttons.

When color of distance markers is seen as **RED** color, user can adjust the lines **UP/DOWN** or **LEFT/RIGHT**.

When both color of distance markers are seen as **RED** color, both lines can be adjusted **LEFT/RIGHT**.

When left color of distance marker is seen as **RED** color, left line of distance marker can be adjusted **LEFT/RIGHT**.

When right color of distance marker is seen as **RED** color, right line of distance marker can be adjusted **LEFT/RIGHT**.

Marker B- Horizontal line

User can adjust the **UP/ DOWN** of the lines.

User can adjust horizontal line by pressing **[UP/DOWN]** buttons.



LOCK ON/OFF FUNCTION

LOCK ON/OFF FUNCTION

The set up menu can be locked as prevention against unauthorized users.

LOCK ON mode

At **Power-ON** mode, hold **[DOWN]** button pressed for 10 seconds to set up **LOCK ON** function.

When **[LOCKED]** is displayed on the screen, user can use **[POWER, SELECT, VOLUME]** buttons only and use can do setting for **PICTURE** menu.

LOCK OFF mode

At **Power-ON** mode, hold **[DOWN]** button pressed for 10 seconds to set up **LOCK OFF** function.

When **[UNLOCKED]** is displayed on the screen, user can use all functions of the set up menu.



SCAN ON/OFF FUNCTION

At **Power-ON** mode, hold **[UP]** buttons pressed for 4 seconds to activate Auto Scan Picture function.

During the auto scanning mode, press **[UP]** button for 4 seconds to inactivate Auto Scan Picture function.

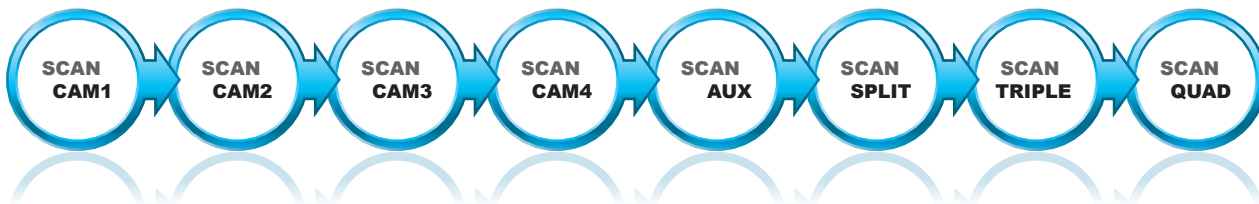

INSTALLATION

MONITOR installation with STAND BRACKET & SUNVISOR

- A** Remove a protection tape and attach **STAND BRACKET** into stand place, then fix it with the supplied screws.
- B** Connect **STAND BRACKET** with monitor and adjust height/angle.
- C** Attach **SUNVISOR** to the **MONITOR** and fix it with the supplied screws.
- D** Connect **CAMERA INPUT CABLE** to the **MONITOR**.

A

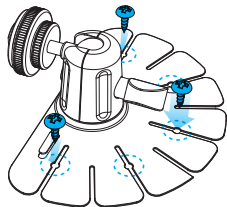

B

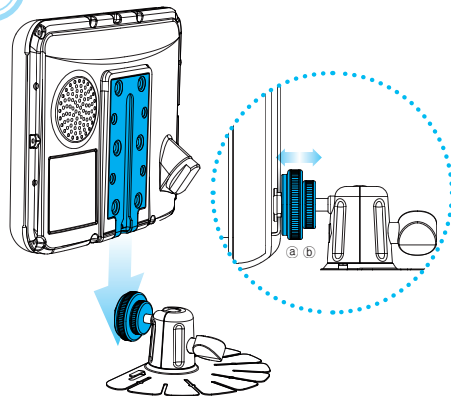

C

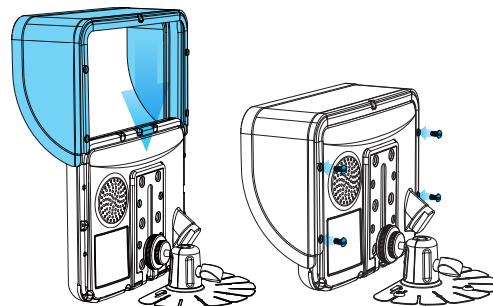

D

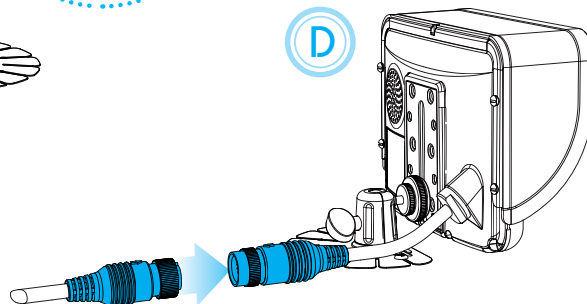

Installation of HEAVY DUTY MOUNTING BRACKETS

MONITOR can be connected with different type of heavy duty mounting brackets.

Please check the compatibility in advance, then please follow installation as described below.

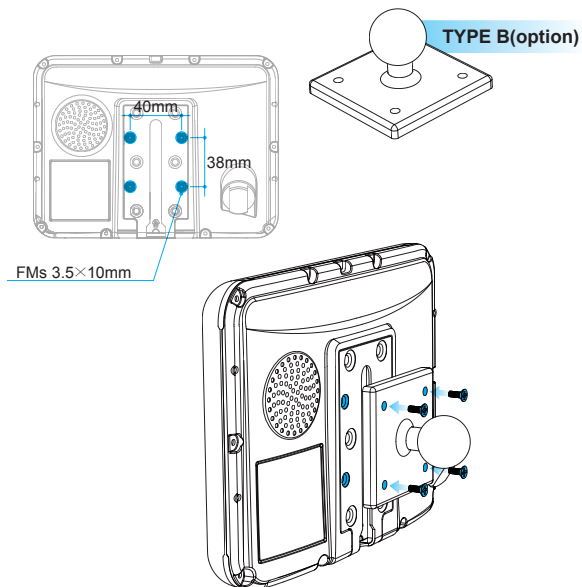
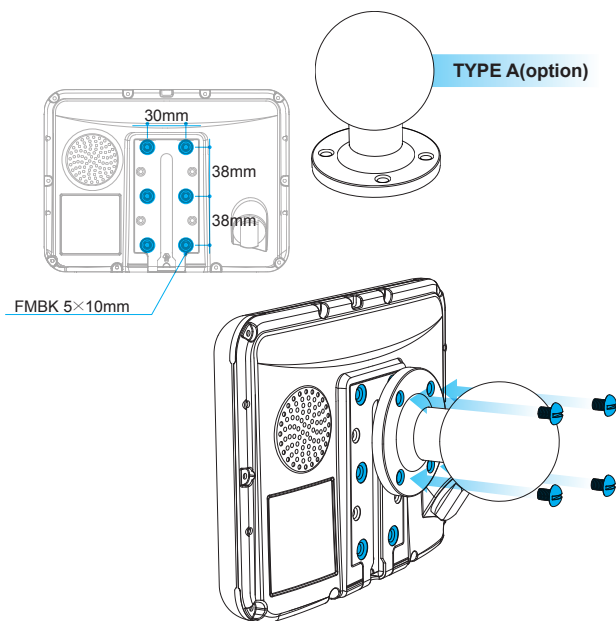

CONNECTION

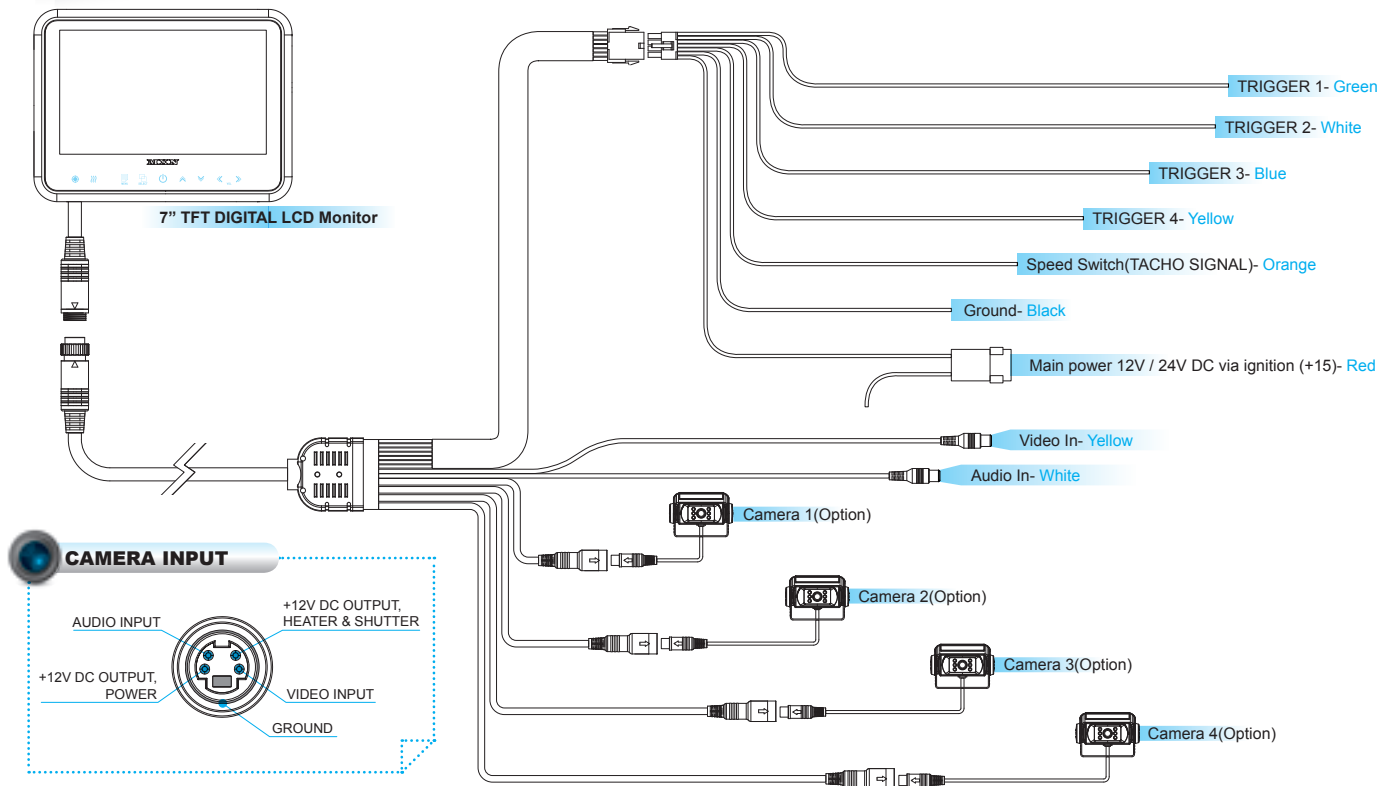



SPECIFICATION

7" TFT DIGITAL LCD MONITOR

ITEM	SPECIFICATION
LCD Screen Size	7" Wide Diagonal
Dimensions	190(W) × 142(H) × 42.85(D)mm
Display dimensions	152.4 × 91.44mm
Power Input	DC 12 to 30 Volt Free Input
Power Consumption	15 Watt Max.
Video System	NTSC / PAL
Sync. System	Internal
Brightness	500 cd/m ²
Display Resolution	800 × 480 pixel
Viewing Angle	Top: 50. Bottom: 60. Left: 65. Right: 65.
Color Configuration	RGB Stripe
Dimmer	Automatic / Manual
Speaker Impedance	8 ohm, 0.3 Watt Max.
Operating Temp.	-25°C ~ +75°C
Storage Temp.	-30°C to + 85°C
Impact Rating	4G
Camera Connector	4-pin mini DIN (MXN configuration)
Housing	Soft black(Al12)
ON-Screen Display Control Functions	Volume · Brightness · Color · Contrast · Tint · CAM Screen 1/2/3/4 SPLIT TRIPLE QUAD · CAM Trigger 1/2/3/4 · Heater · Speedswitch · Auto Power · Distance marker · Auto Picture Scan · Dimmer · Language · Direction · Reset.
Supplied Accessory	Die-Cast Mounting Bracket / 1 pce, Screw Kit / 1set, Manual, Sun Shield / 1 pce, Power cable / 1 set
Weight	790g



MEMO

-
-
-
-
-
-
-
-
-
-
-
-



MEMO

-
-
-
-
-
-
-
-
-
-
-
-



7" TFT DIGITAL LCD Monitor

for MXN-HD7DMQ - Owner's Manual

MXN®